



## DATASHEET

# PAN AMT P 04-AMT | RJ – PASSIVE FULL-RANGE LINE ARRAY (D'APPOLITO)



Illustration without bracket



Illustration with bracket



Illustration in colour option, see properties for details.

## EQUIPMENT / OPTIONS



See last page for explanation of the symbols.

## APPLICATIONS

Churches, museums, train stations, airports, legislative buildings, conference rooms, lecture halls, surround, A/V presentation rooms, immersive sound

The **Pan AMT P 04-AMT | RJ** is a passive full-range line array (D'APPOLITO) in an attractive compact column for speech and music applications. It is characterised by a high level of fine detail and excellent resolution even at the highest frequencies. Thanks to its integrated RJ45 socket\*\*, this loudspeaker can be very easily used in buildings with structured cabling.

The loudspeaker contains four 3.5" HQ drivers and a specially developed **AMT tweeter unit from Mundorf**. The enclosure is made of aluminium and can be custom-finished in any colour. The chassis are protected from external impact by a perforated metal sheet that is integrated into the design.

At the back of the **P 04-AMT | RJ** there is an RJ45 socket with special wiring for the low-impedance audio signal connection. The optional mounting accessories (wall, ceiling and tripod mounts) can be installed by inserting a slot nut in the lateral slots and the rear slot. The **P 04-AMT | RJ** can be optionally ordered with or without U-bracket.

The **P 04-AMT | RJ** can be operated individually or in combination with the P SW-108 | RJ from the Pan Subwoofer series.

## FEATURES

High efficiency, integrated protection circuit, high reproduction quality even in acoustically challenging environments, sleek, unobtrusive design.

## MOUNTING ACCESSORIES

For the **Pan AMT** series, there is a wide range of mounting accessories for fixed installation and mobile use.

All **Pan AMT** loudspeakers are designed, developed and manufactured in Germany by Pan Acoustics according to strict criteria and with high-quality materials.



## TECHNICAL DATA P 04-AMT | RJ

### ACOUSTIC PROPERTIES

<b>Configuration:</b>	Passive full-range line array (D'APPOLITO)
<b>Frequency range:</b>	90 Hz - 24 kHz
<b>Equipment:</b>	4 x 3.5" + 1 x Air Motion Transformer (AMT)
<b>Rated power:</b>	400 W (peak <sub>20 ms</sub> ) / 200 W (programme) / 100 W (nominal)
<b>Recommended amplifier:</b>	DSP power amplifier   at least 600 W @ 4 ohms per channel
<b>Sensitivity:</b>	93 dB 1 W / 1 m
<b>Maximum SPL:</b>	120 dB / 1 m*
<b>Impedance:</b>	4 ohms
<b>Horizontal radiation pattern:</b>	130°
<b>Vertical radiation pattern:</b>	20°
<b>Connections:</b>	1 x RJ45**
<b>Temperature range:</b>	-10 °C to +50 °C (ambient temperature)

### MECHANICAL PROPERTIES

<b>Enclosure:</b>	Aluminium profile
<b>Grille:</b>	Powder-coated perforated metal sheet
<b>Standard colours (with silver lids): (optional: lid in enclosure colour)</b>	RAL 9006 (aluminium), anodised RAL 9010 (white), silk matt RAL 9005 (black), silk matt
<b>Dimensions without bracket (HxWxD): Dimensions with bracket (HxWxD):</b>	506 x 107 x 118 [mm] 522 x 107 x 137/152 [mm]
<b>Weight:</b>	3 kg
<b>Mounting option:</b>	Extensive range of mounting accessories available

\*Under anechoic half-space conditions with DSP settings.

Frequency range: -10 dB under anechoic half-space conditions.

\*\*Large cable lengths and small wire cross-sections can greatly reduce the max. power.

TECHNICAL DRAWING P 04-AMT | RJ

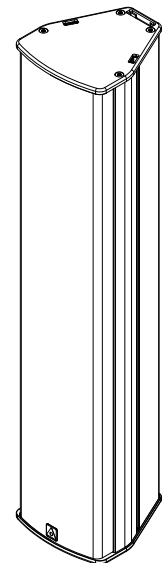
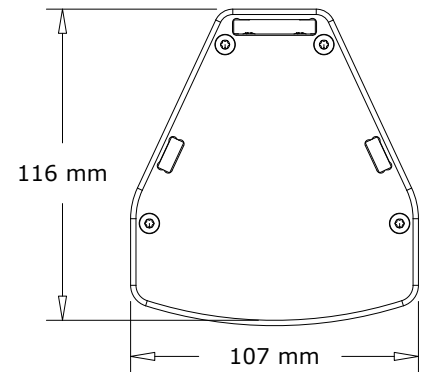
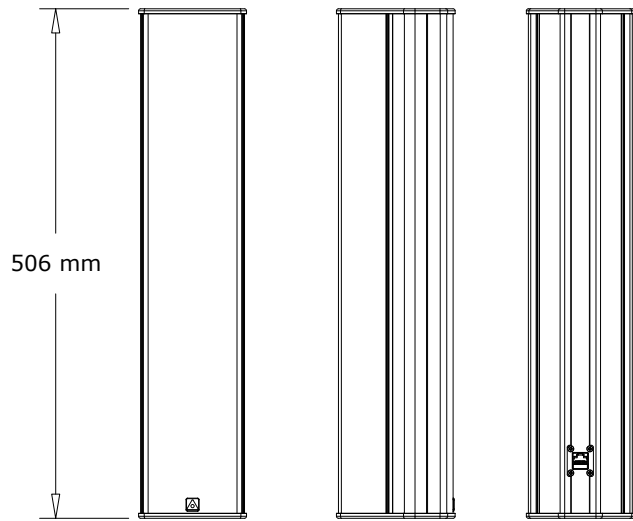

TECHNICAL DRAWING P 04-AMT | RJ (with bracket)

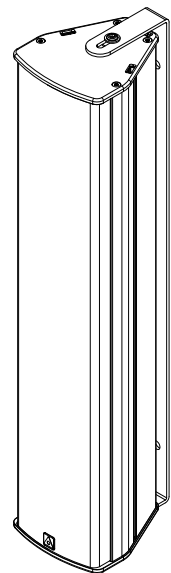
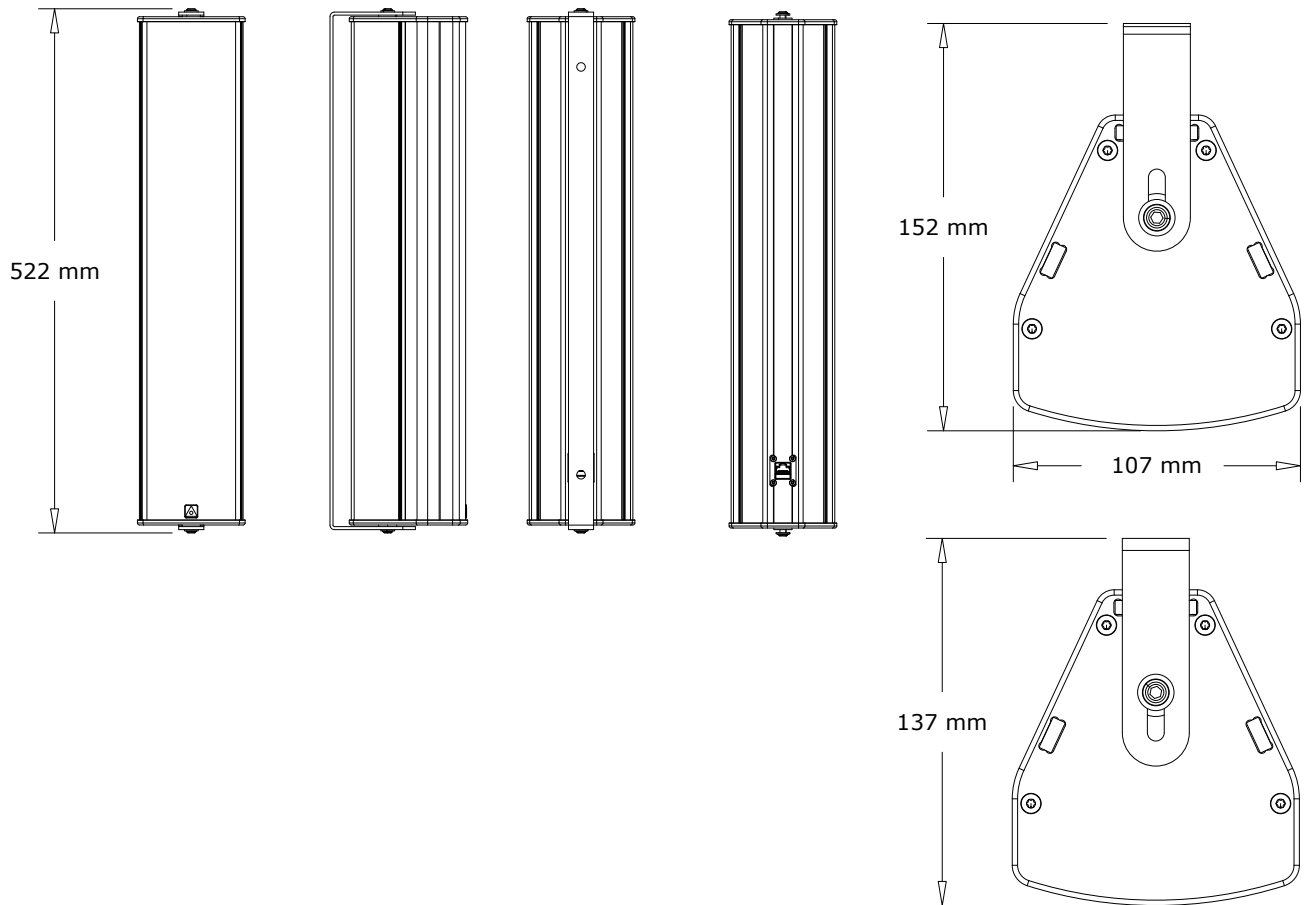



## EQUIPMENT / OPTIONS AT GLANCE – PAN AMT SERIES



**Customised painting/colouring**  
within the RAL colour range. Other colour ranges such as RAL design, Pantone, etc. available on request.



**Accessories** such as wall, tripod and ceiling mounts, different interfaces, connection cables, weather protection hoods and connection sets are available.



**Ball impact resistance**



**Looks good, sounds good.**

Pan Acoustics' products are defined by natural sound and attractive design.

Some equipment features cannot be combined. For information about which features can be combined with each other, please send an e-mail to [sales@pan-acoustics.de](mailto:sales@pan-acoustics.de).

## Our quality promise

**Pan Acoustics stands by its products and gives up to 10 years warranty** on its loudspeakers for any material or manufacturing defects. New products manufactured in accordance with protection classes IP54 and IP65 as well as digital audio interfaces (Dante ® from Audinate Pty Ltd and rechargeable batteries are excluded from the 10-year warranty. A warranty period of 3 years is granted for loudspeakers in accordance with protection classes IP54 and IP 65.

