

DATASHEET

**ROTATABLE WALL MOUNT (TWM II)**  
FOR P / PB XX LOUDSPEAKER SYSTEMS



The **rotatable wall mount (TWM II)** for **P / PB xx loudspeaker systems** from the **Pan Accessories series** can be used to accommodate the P / PB xx models of the **Pan Beam, Pan Speaker, Pan 2-Line and Pan AMT loudspeaker system range**.

The accessory is made of steel and can be powder-coated to match the colour scheme of the loudspeaker. The wall mount is designed for secure mounting of the loudspeakers to wall surfaces and can only be detached with tools.

The wall mount is attached to the loudspeaker via the rear slot. One mounting unit is attached to the top of the loudspeaker and one to the bottom of the loudspeaker. The wall mount is supplied as a set.

The wall mount provides a horizontal speaker swivel range of +/- 95°. The wall mounting bracket can be attached to the wall with either the long or the short leg in order to realise corresponding wall distances or also a lateral mounting of the loudspeaker.

**EQUIPMENT / OPTIONS**



See last page for explanation of the symbols.

**APPLICATIONS**

Wall mounting

All **Pan Acoustics** loudspeakers and the corresponding accessories are designed, developed and manufactured in Germany by Pan Acoustics according to strict criteria and with high-quality materials.

**TECHNICAL DATA: ROTABLE WALL MOUNT (TWM II)**

**MECHANICAL PROPERTIES**

<b>Material:</b>	Stainless steel
<b>Speaker swivel range</b> Vertical:	0°
Horizontal:	190° (+/- 95°)
<b>Load capacity:</b>	max. 13 kg
<b>Standard colour:</b>	Steel
<b>Dimensions without loudspeaker (H x W x D):</b>	120 x 80 x 40 [mm]
<b>Weight per wall mount:</b>	0.2 kg

**TECHNICAL DRAWING**

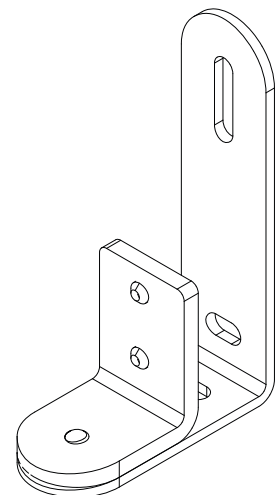
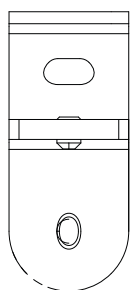
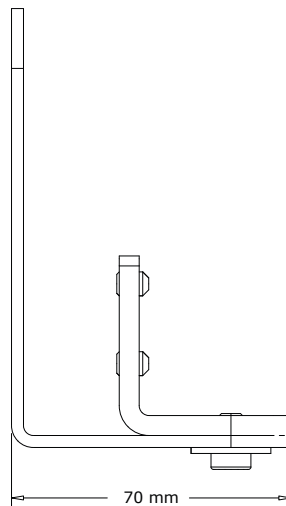
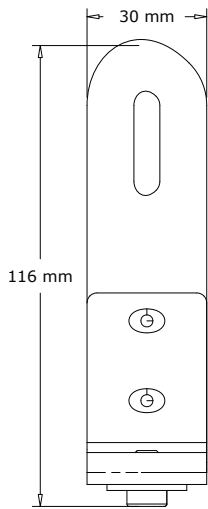

**EQUIPMENT / OPTIONS AT GLANCE – ACCESSORIES**



**Customised painting/colouring** within the RAL colour range. Other colour ranges such as RAL design, Pantone, etc. are available on request.



**Looks good, sounds good.** Pan Acoustics' products are defined by natural sound and attractive design.

Some equipment features cannot be combined. For information about which features can be combined with each other, please send an e-mail to [sales@pan-acoustics.de](mailto:sales@pan-acoustics.de).

**Our quality promise**

**Pan Acoustics** stands by its products and gives up to **10 years warranty** on its loudspeakers for any material or manufacturing defects. New products manufactured in accordance with protection classes IP54 and IP65 as well as digital audio interfaces (Dante®) from Audinate Pty Ltd and rechargeable batteries are excluded from the 10-year warranty. A warranty period of 3 years is granted for loudspeakers in accordance with protection classes IP54 and IP65.

